

HJM180M-24 180Wp (MONO CRYSTALLINE)

High Efficiency, High Quality PV Module

High power module using 125mm single crystal silicon solar cells. This module with bypass diode minimizes the power drop by the shade.

- Bypass diode minimizes the power drop by shade
- The conversion efficiency of solar cell is over 17%
- White tempered glass, EVA resin, weather proof film and anodized aluminum frame provide efficient protection from the severe environmental conditions
- Waterproof (UL94, V-O) connector provide nominal 24 DC output. Perfect for grid applications. Using optical low iron tempered glass, EVA resin, module with aluminum frame for outdoor use.

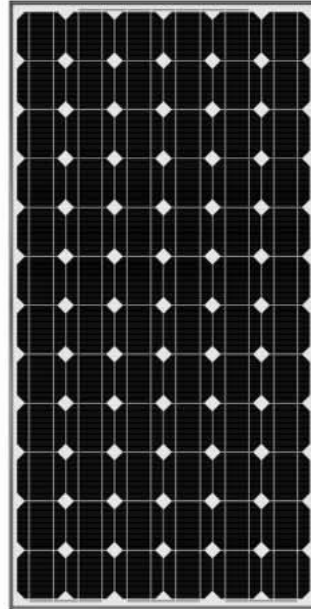

Warranty

- 90% power output over 12 years
- 80% power output over 25 years
- Free from defects in materials and workmanship for 5 years

Electrical Characteristics

Module Type	HJM160M-24	HJM165M-24	HJM170M-24	HJM175M-24	HJM180M-24	HJM185M-24
Maximum power at STC(Pmax)	160Wp	165Wp	170Wp	175Wp	180Wp	185Wp
Short-circuit current(Isc)	5.10	5.36	5.41	5.43	5.48	5.50
Open-circuit voltage(Voc)	44.2	44.3	44.4	44.7	44.8	45
Optimum operating current(Imp)	4.57	4.71	4.77	4.88	5.00	5.11
Optimum operating voltage(Vmp)	35.0	35.0	35.6	35.8	36.0	36.2

Quality and Safety

Hengji PV modules are manufactured in our ISO 9001-certified factories, listed by Underwriter's Laboratories for electrical and fire safety (Class C fire rating), certified by TÜV Rheinland IEC61730 and comply with the requirements of IEC 61215 including:

- repetitive cycling between -40°C and 85°C at 85% relative humidity;
- simulated impact of 25mm (one-inch) hail at terminal velocity;
- a "damp heat" test, consisting of 1000 hours of exposure to 85°C and 85% relative humidity;
- a "hot-spot" test, which determines a module's ability to tolerate localized shadowing (which can cause reverse-biased operation and localized heating);
- static loading, front and back, of 2400 pascals (50 psf); front loading (e.g. snow) of 5400 pascals (113 psf).

Specifications

Cell	Monocrystalline silicon solar cells 125mm*125mm
No. of cells and connections	72 (12*6)
Dimension of module	1580mm*808mm*45mm
Weight	15.5kg

Output

Cable	LAPP(4mm ²)
Asymmetrical Lengths	900mm (-) and 900mm (+)
Connection	Type IV

Module Diagram

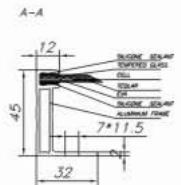
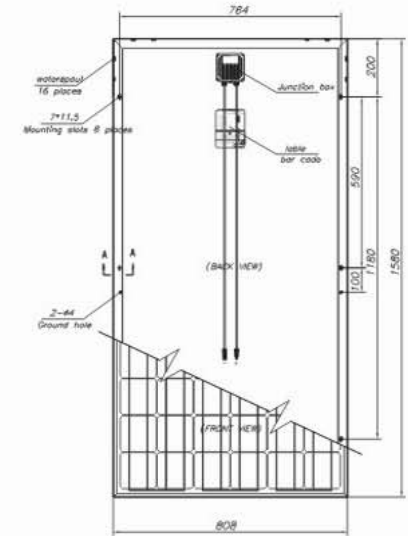

Temperature Coefficients

NOCT	48°C ± 2°C
Current temperature coefficient	(0.055 ± 0.01) %/K
Voltage temperature coefficient	-(0.34 ± 0.01) %/K
Power temperature coefficient	-(0.48 ± 0.05) %/K
Power tolerance	± 3%

NOCT: Nominal Operating Cell Temperature